

Screw Mounting Bases

Low-Profile Cable Tie Mounts

These cable tie mounts are compact in size. They are designed for simple yet robust installation particularly in areas with limited space. They pair with a cable tie for mounting applications including telecom equipment, switchgear and control cabinets.

Features and Benefits

- Compact size for areas with limited mounting space.
- Simple to install with a screw or rivet.
- Single hole attachment with two-way entry for cable tie.

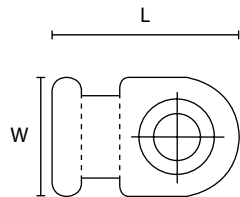

| PART NO. | TYPE | Cable Tie Series | Mounting Screw Type | Length (L) in. (mm) | Width (W) in. (mm) | Height in. (mm) | Material | Color | Pkg. Qty. |
|----------|------|------------------|---------------------|------------------------|-----------------------|--------------------|----------|---------|-----------|
| MB19C2 | MB1 | T18 | #8 (M4) Screw | 0.5 (12.7) | 0.3 (7.9) | 0.1 (3.3) | PA66 | Natural | 100 |
| MB19M4 | | T18 | #8 (M4) Screw | 0.5 (12.7) | 0.3 (7.9) | 0.1 (3.3) | PA66 | Natural | 1000 |
| MB10C2 | | T18 | #8 (M4) Screw | 0.5 (12.7) | 0.3 (7.9) | 0.1 (3.3) | PA66 | Black | 100 |
| MB10M4 | | T18 | #8 (M4) Screw | 0.5 (12.7) | 0.3 (7.9) | 0.1 (3.3) | PA66 | Black | 1000 |
| MB29C2 | MB2 | T18 - T50 | #8 (M4) Screw | 0.8 (20.6) | 0.5 (12.5) | 0.1 (3.3) | PA66 | Natural | 100 |
| MB29M4 | | T18 - T50 | #8 (M4) Screw | 0.8 (20.6) | 0.5 (12.5) | 0.1 (3.3) | PA66 | Natural | 1000 |

Dimensions are approximate and subject to technical changes. Use Part No. for ordering and Type for specification purposes.